

implicite y otros no permiten excluir o limitar los daños fortuitos o emergentes, razón por la cual algunas de las limitaciones antes mencionadas pueden no ser aplicables a su caso.

PROCEDIMIENTOS DE LA GARANTÍA
PARA OBTENER SERVICIO CONFORME A LAS CONDICIONES DE ESTA GARANTÍA:

Sírvase hacer lo siguiente:

1. Mande una copia de la factura original indicando la fecha de compra y su dirección postal, además de una nota describiendo la naturaleza del problema a:

Royal Consumer Information Products, Inc.
Warranty Processing
P.O. Box 6786
Somerset, NJ 08875-6786 EE.UU. / USA

POR FAVOR, no envíe el producto a la dirección antes mencionada

2. Si se considera que hay una razón para cambiar el producto, recibirá un número de autorización de devolución dentro de los próximos 7 a 12 días laborables, contados a partir de la fecha de recepción de su solicitud. El formulario de autorización de devolución que usted reciba le dará los procedimientos que debe seguir para la devolución, los cargos aplicables, si los hay, y la dirección donde debe enviar el artículo.

LÍNEA DE SERVICIO AL CLIENTE:

Para obtener información sobre el uso de este producto llame al 1-800-272-6229 o +1-732-627-9977 [México 01-800-849-4826], de lunes a viernes, entre las 8:30 h y las 17:00 h, hora del Este. Asimismo pueden mandar una nota por correo electrónico a Royal a hotline@royal.com.

FRENCH: GARANTIE et SERVICE TECHNIQUE

CONSERVEZ PRÉCIEUSEMENT VOTRE PREUVE D'ACHAT

Votre nouvel appareil de marque Olivetti / Royal est garanti par ROYAL CONSUMER INFORMATION PRODUCTS, INC. (Royal), 379 Campus Drive, 2nd Floor, Somerset, NJ 08875 USA, contre toutes déficiences de matériaux ou de fabrication. Dans le cas d'un problème ou d'un défaut, la garantie de Royal s'appliquera comme suit:

Pièces: Remplacement par des pièces neuves ou réusinées pour une période de **un (1) an** suivant la date d'achat original.

Main d'oeuvre: Pour une période de **90 jours** suivant la date d'achat original. Le produit doit être expédié, frais de port et d'assurances pré-payés à ROYAL. Les frais de retour de même que les pièces ou main d'oeuvre non couvertes par la garantie seront facturés au propriétaire.

Cette garantie ne s'applique qu'à l'acheteur original du produit et ne peut être transférée en cas de vente ou d'achat de l'appareil usagé. Elle ne s'applique pas aux réparations et aux dommages résultant et ne se limitant pas à une mauvaise utilisation, le feu, les accidents, la négligence et l'abus.

LA GARANTIE CI-HAUT MENTIONNÉE EST LA SEULE GARANTIE FAITE PAR ROYAL. ROYAL NE FAIT PAS ET NE RESPECTE PAS D'AUTRES GARANTIES EXPRIMÉES OU IMPLICITES INCLUANT LES GARANTIES DE SATISFACTION À UN USAGE PARTICULIER.

ROYAL ne sera tenu responsable d'aucun dommage ou conséquence résultant d'un défaut, d'un mauvais fonctionnement ou de blessures causées par l'utilisation de ce produit. En aucun cas Royal ne sera tenu responsable pour toutes pertes ou dommages à l'acheteur dépassant la valeur d'achat de l'appareil. La responsabilité de Royal ne se limite qu'à la valeur de remplacement de son produit. Certaines dispositions mentionnées peuvent ne pas s'appliquer dans votre région. Cette garantie vous donne des droits légaux variant d'une province à l'autre. Informez-vous

MARCHE À SUIVRE POUR UTILISER VOTRE GARANTIE
POUR UNE RÉPARATION AYANT ATTRAIT À CETTE GARANTIE:

Suivez la procédure suivante:

1. Envoyez une copie de votre preuve d'achat (gardez l'original dans vos dossiers) indiquant la date d'achat originale avec une note indiquant votre adresse de retour et une description détaillée du problème rencontré à:

NE RETOURNEZ PAS L'APPAREIL À CETTE ADRESSE!

Royal Consumer Information Products, Inc.
Warranty Processing
P.O. Box 6786
Somerset, NJ 08875-6786 USA

2. Vous recevrez un numéro d'autorisation pour votre retour dans les 7 à 12 jours ouvrables suivant votre demande de retour si nous établissons qu'il y a matière à retour. L'autorisation de retour comporte la marche à suivre, les frais, s'il y a lieu de même que l'adresse de l'atelier pour retourner votre appareil.

Pour toutes questions sur ce produit ou son utilisation, contactez-nous du lundi au vendredi au 1-800-272-6229 (Canada 1-888-266-9380) entre 8h30 et 17h00 heure normale de l'est. Vous pouvez également nous rejoindre via courrier électronique au hotline@royal.com.

WIRELESS STEREO SPEAKER SYSTEM

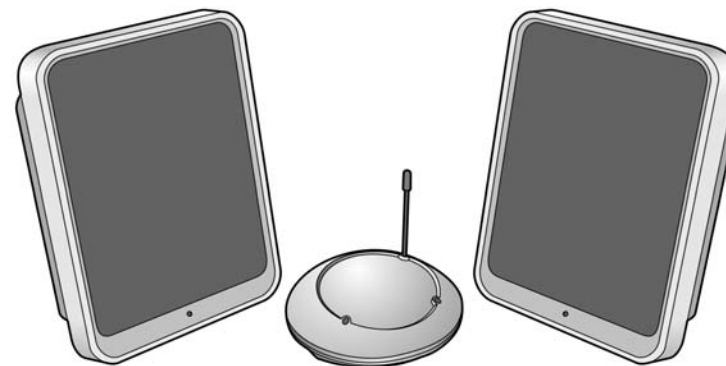

**ROYAL
WES 600**

Owner's Manual

INTRODUCTION

The 900 MHz stereo wireless speaker system uses latest wireless technology that enables you to enjoy music and TV sound anywhere inside or outside your home. You can simply connect the system to any audio source such as Radio, TV, VCR, Hi-Fi and CD/MP3/VCD/DVD player. Without complicated wiring and installation with your Audio/Video equipments and rear channel amplifier, the system enables you to enjoy thrilling, lifelike sound stereo in minutes.

FEATURES

900 MHz RF technology panel-like speaker system.
Phase Lock Loop (PLL) technology on transmitter.
RF technology lets you roam freely throughout your house.
Operating distance up to 50 Meters.
No line of sight limitation.
Virtually interference free stereo quality.
ALC and auto ON/OFF control.
Auto tuning function.
Bass boost function

INSTALLATION

TRANSMITTER

Insert the antenna tube into the antenna wire.



Connect the supplied AC power adaptor to an electrical wall outlet.
Plug the AC power adaptor in the DC jack located on the rear of the transmitter.

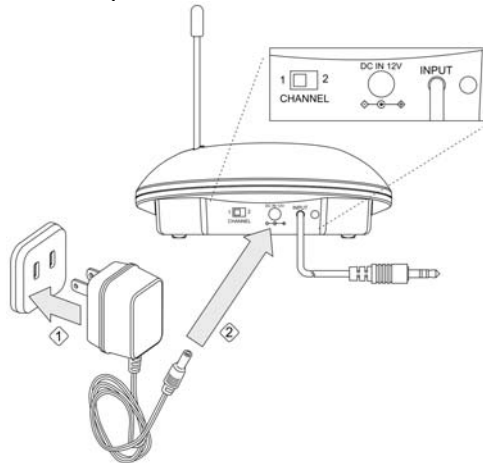

WARRANTY, REGISTRATION & TECHNICAL SUPPORT

BE SURE TO KEEP A COPY OF YOUR SALES RECEIPT!

STANDARD WARRANTY

ROYAL CONSUMER INFORMATION PRODUCTS, INC. ("Royal"), at 379 Campus Drive, 2nd Floor, Somerset, NJ 08875 USA WARRANTS that your NEW product is free of defects of workmanship and materials. If there is a defect or malfunction of this product, Royal will repair it free of charge as follows:

PARTS: New or comparable rebuilt parts in exchange for defective parts for ONE (1) YEAR from date of customer purchase.

LABOR: Royal provides labor warranty for NINETY (90) DAYS from date of end-user purchase. Product must be sent postage prepaid and insured to Royal in accordance with the warranty procedures outlined below. At completion of the repair, the consumer will be responsible for return shipping charges from Royal, and for any parts or services no longer covered under warranty.

This warranty does not apply to persons who purchased this product second-hand or used.

This warranty does not include adjustments, parts and/or repairs required by circumstances beyond the control of Royal, including but not limited to fire or other casualty, accident, neglect, abuse, misuse, abnormal use or battery leakage damages.

THERE ARE NO OTHER EXPRESSED WARRANTIES EXCEPT AS STATED HEREIN. AFTER THE PERIOD OF EXPRESSED WARRANTY SET FORTH HEREIN, THERE ARE NO EXPRESSED OR IMPLIED WARRANTIES AND THOSE EXCLUDED INCLUDE THOSE OF MERCHANTABILITY AND FITNESS FOR PARTICULAR PURPOSE. Royal shall NOT be held liable for CONSEQUENTIAL DAMAGES resulting from any failure, defect or malfunction of this product. Some States do not allow limitations on how long an implied warranty lasts and some States do not allow the exclusion or limitation of incidental or consequential damages, so the above limitations may not apply to you.

WARRANTY PROCEDURES

TO OBTAIN SERVICE UNDER THE TERMS OF THIS WARRANTY:

Please do the following:

1. Send a copy of your original sales receipt showing original purchase date, along with your mailing address and a note describing the nature of the problem to:

Royal Consumer Information Products, Inc.
Warranty Processing
P.O. Box 6786
Somerset, NJ 08875-6786 USA

Do Not Return the Product to This Address!

2. You will receive a return authorization number within 7-12 business days from the date your return request is received if it is determined that there is a basis for a replacement product. The return authorization form you receive will list the return procedures, applicable charges, if any, and the correct shipping address for the returned product.

PRODUCT SUPPORT HOTLINE:

For questions on use of this product or this warranty call 1-800-272-6229 (in Canada call 1-888-266-9380 or in Mexico call +(52-55)-53-33-1333), Monday through Friday during normal business hours. You can also e-mail Royal at hotline@royal.com.

SPANISH:

GARANTÍA, REGISTRO Y APOYO TÉCNICO

¡GUARDE MUY BIEN UNA COPIA DE LA FACTURA DE COMPRA!

GARANTÍA ESTÁNDAR

ROYAL CONSUMER INFORMATION PRODUCTS, INC. ("Royal"), 379 Campus Drive, 2nd Floor, Somerset, NJ 08875 EE.UU./USA GARANTIZA que su NUEVO producto está libre de defectos de fabricación y de materiales. Si este producto tiene un defecto o funciona mal, Royal lo reparará sin cargo alguno, de acuerdo a las siguientes estipulaciones:

PIEZAS: nuevas o reacondicionadas para sustituir piezas defectuosas, por UN AÑO a partir de la fecha de compra del usuario final.

MANO DE OBRA: Royal garantiza la mano de obra por NOVENTA DÍAS a partir de la fecha de compra del usuario final. El artículo deberá enviarse asegurado y con franqueo pagado a Royal, conforme a los procedimientos de la garantía indicados a continuación. Al terminar las reparaciones, el consumidor será responsable de pagar los cargos de devolución desde Royal y los costos de todas las piezas o servicio que no estén cubiertos por la garantía.

La presente garantía no se aplica a las personas que hayan comprado este producto de segunda mano o usado.

La presente garantía no incluye ajustes, piezas y reparaciones requeridas por circunstancias fuera del control de Royal, entre otras, incendio u otro tipo de desastre, accidente, descuido, abuso, mal uso o daños causados por fugas de baterías.

NO EXISTEN OTRAS GARANTÍAS EXPRESAS EXCEPTO LA PRESENTE. DESPUÉS DEL PERÍODO DE VIGENCIA DE LA GARANTÍA, NO EXISTIRÁ NINGUNA OTRA GARANTÍA EXPLÍCITA O IMPLÍCITA Y SE EXCLUYEN LA DE COMERCIABILIDAD Y ADECUACIÓN DEL PRODUCTO A UN FIN PARTICULAR. Royal NO SERÁ RESPONSABLE de los DAÑOS EMERGENTES que resulten de fallas, defectos o mal funcionamiento de este producto. Algunos estados no permiten limitar la duración de una garantía

Switching off

Turn the VOLUME ON/OFF knob until the click sound is heard to turn off the speaker and the LED light goes off

For protection of the transmitter and power saving, the transmitter will cut off automatically if there is no/weak operation input signal from audio source for 4 minutes.

In other words, if the signal comes back, the transmitter will work again automatically.

TROUBLE SHOOTING

NO SOUND

Ensure the AC adaptor is fully inserted into the AC outlet and the power connection input on the transmitter.

Ensure the speaker is switch ON.

Speaker's battery capacity is too low, replace with new batteries or connect the AC adaptors to the speakers.

Ensure the TV or audio component is ON.

The connected audio / video equipment is not playing. Start playing the equipment.

The volume of speaker is too low, adjust the volume to an appropriate level.

DISTORTED

Press the "SCAN" button on the speakers until matching the frequency of the transmitter.

Change the position of the channel selector on the transmitter. You must then press the SCAN button on the speaker.

Battery capacity is too low. Replace with the new battery.

Ensure the volume level of speakers is adjusted properly.

The speaker is too far from transmitter, move closer.

The input level of the audio signal is too low. Turn up the volume of the audio source equipment.

The following is given in accordance with California Proposition 65.

WARNING: This product contains chemicals known to the State of California to cause cancer, birth defects, or other reproductive harm. *Wash hands after handling.*

FEDERAL COMMUNICATIONS COMMISSION (FCC) RADIO FREQUENCY INTERFERENCE STATEMENT INFORMATION TO THE USER:

This device complies with Part 15 of the FCC Rules. Operation is subject to the following two conditions: (1) This device may not cause harmful interference, and (2) This device must accept any interference received, including interference that may cause undesired operation.

Warning: Changes or modifications to this unit not expressly approved by the party responsible for compliance could void the user's authority to operate the equipment.

NOTE: This equipment has been tested and found to comply with the limits for a Class B digital device, pursuant to Part 15 of the FCC Rules. These limits are designed to provide reasonable protection against harmful interference in a residential installation. This equipment generates, uses and can radiate radio frequency energy and, if not installed and used in accordance with the instructions, may cause harmful interference to radio communications.

However, there is no guarantee that interference will not occur in a particular installation. If this equipment does cause harmful interference to radio or television reception, which can be determined by turning the equipment off and on, the user is encouraged to try to correct the interference by one or more of the following measures:

- Reorient or relocate the receiving antenna.
- Increase the separation between the equipment and receiver.
- Connect the equipment into an outlet on a circuit different from that to which the receiver is needed.
- Consult the dealer or an experienced radio/TV technician for help.

Notes: Shielded cables must be used with this unit to ensure compliance with the Class B FCC limits.

The Responsible party information:

Royal Consumer Information Products, Inc. – 379 Campus Drive, 2nd Floor, Somerset, NJ 08875, USA
TEL: 732-627-9977

IN CANADA:

This digital apparatus does not exceed the Class B limits for radio noise emissions from digital apparatus as set forth in the radio interference regulations of the Canadian Department of Communications.

AU CANADA:

Cet appareil digital respecte les normes de la Classe B pour les émissions de fréquences radio telles qu'indiquées dans la loi sur les interférences radio et mises en application par le département canadien des communications.

The rear of the transmitter has one audio cord that can be connected to audio output jack of TV, Monitor, VCR, Radio recorder, CD/MP3/VCD/DVD players or to headphone/earphone jack with the connector provided.

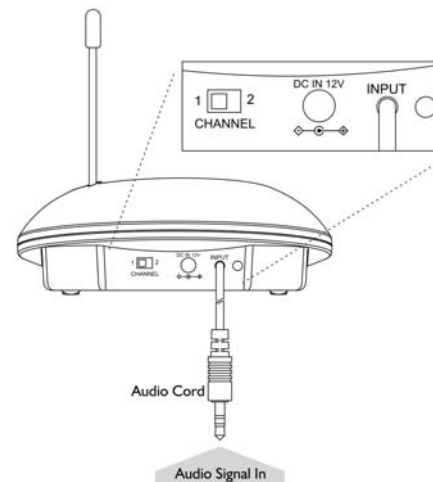

Plug the adaptor in the AC source and connect the audio plug to the audio source. As soon as the transmitter is receiving the audio signal, it will automatically switch on and the red LED will illuminate

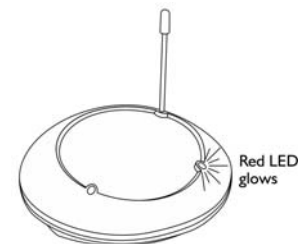

SPEAKER RECEIVER

Insert 6 pieces 'AA' size ALKALINE battery into the battery compartment with correct polarity at the rear of the speaker or connect the 12V power adaptor to the DC input jack on the rear of each speaker, then plug it to the wall AC outlet.

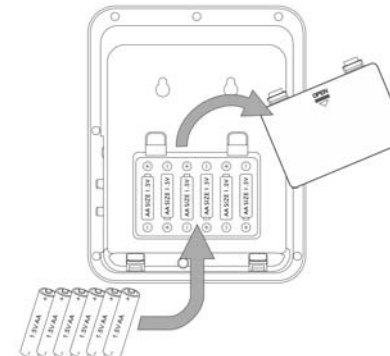

Switch on the speaker by turning up the VOLUME ON/OFF knob towards ON direction. The POWER/STEREO LED will light up. Switch off the speaker by turning down the VOLUME ON/OFF knob towards OFF direction until a "click" sound is heard.

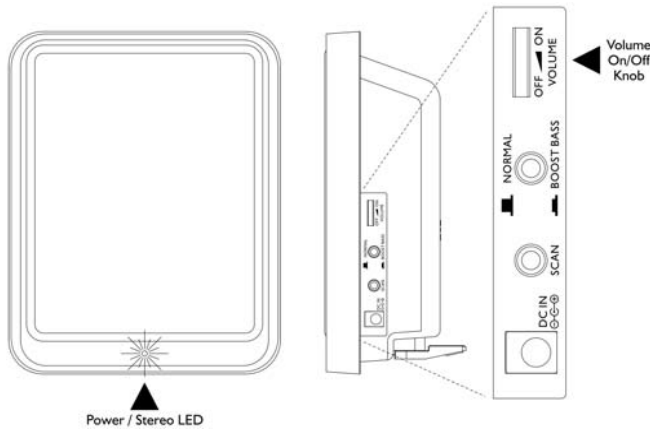

OPERATION

Turn on the audio source (TV or audio component) to which the transmitter is connected with. The LED on transmitter will light up.

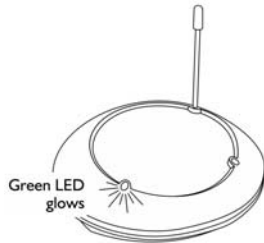

Select the channel 1 or 2 of the transmitter for best performance in your location.

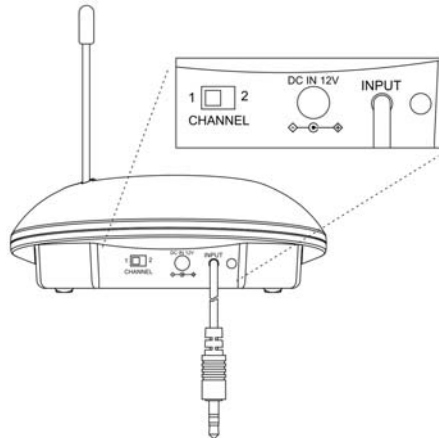

Turn on the ON/OFF VOLUME knob on the speaker and adjust the volume to the desired listening level. Push the "SCAN" auto-tuning button to get the best tuning reception in the speakers.

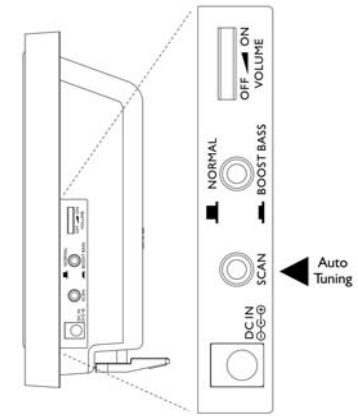

When the button is pressed, frequency tuning starts automatically and it stops when a signal is detected. The POWER/STEREO LED will change from red to green.

A). Keep a distance of the speaker up to 7 meters apart from transmitter, and then press "SCAN" auto-tuning button for best tuning reception.

B) Whenever you find frequency jam, move your channel switch from one channel to the other channel (there are two channels for selection) on the transmitter, and then press the "SCAN" auto-tuning button again.

The BOOST BASS button can be used to enhance the bass sound depending on your own music preferences. Turn bass/boost effect ON simply by pressing the button down, and pressing it once again to OFF.

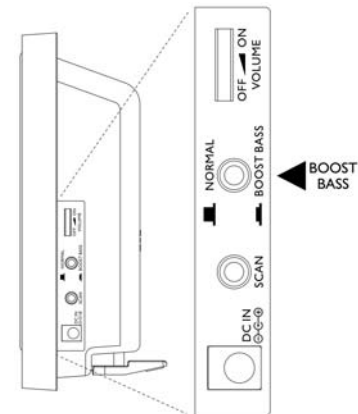

Note

You should now be able to place the speakers freely from room to room without disruption. If disruption should occur (signal breaks up), press the speaker's "SCAN" auto-tuning button to maximize best reception.

If you hear interference from other components, switch the channel control of transmitter, and then move the speakers to other free location. You can re-adjust the tuning control by moving it either channel 1 or, 2 of the transmitter, then pressing "SCAN" auto-tuning button for best reception.

When transmitting / receiving over long distances, the signal from the system will become weaker.